

GLAMOUR + CAMPING
Glamping
by *MaryJane*♥

Quilt is 64" x 80".

Fabric Requirements

16 Patch Blocks: One Glamping Layer Cake™
(11600LC) (42-10" squares)

"X" Block Green print:
1½ yards (11605 13)

"X" Block Background :
2½ yards (9900 200)

Binding: ⅔ yard (11602 15)

Backing: 4 yards

Rick Rack: 28 yards (Trim Trends #RR41 180)

Folded Corner Clipper (502 Prairie Sky#1)

Featuring
GLAMOUR + CAMPING
Glamping
by
MaryJane♥
for Moda.

moda

MODAFABRICS.COM
PS11600 — SUGGESTED RETAIL \$6.00



GLAMOUR + CAMPING

Glamping

by *MaryJane*♥

moda
Quilt is 64" x 80".

GLAMOUR + CAMPING
Glamping by Mary Jane 

Cutting

Quilt is 64" x 80".

16 Patch Blocks: One Layer Cake™.

From 40-10" Layer Cake™ squares cut: 4-2½" x 10" strips

Once you have cut all 40 Layer Cake™ squares you will have 40 sets of 4 matching-2½" x 10" strips.

"X" Block Green print:

20-2½" x width of fabric strips

From EACH strip, cut 16-2½" squares for a total of 320.

"X" Block Background:

18-4½" x width of fabric strips

From EACH strip, cut 9-4½" squares for a total of 162.

(You need 160.)

Binding:

8-2½" x width of fabric strips

Sew the strips together using a diagonal seam to make the Binding.

moda

Construction (Use ¼" seams and press in the direction of the arrows.)

1 "X" Blocks:

(A) Align a 2½" Green square, right sides together, on the upper right corner of a 4½" Background square. Place the Folded Corner Clipper on the Green square as shown. Trim both squares. Sew the pieces together ¼" from the diagonal edge. Press to the corner to form a triangle.

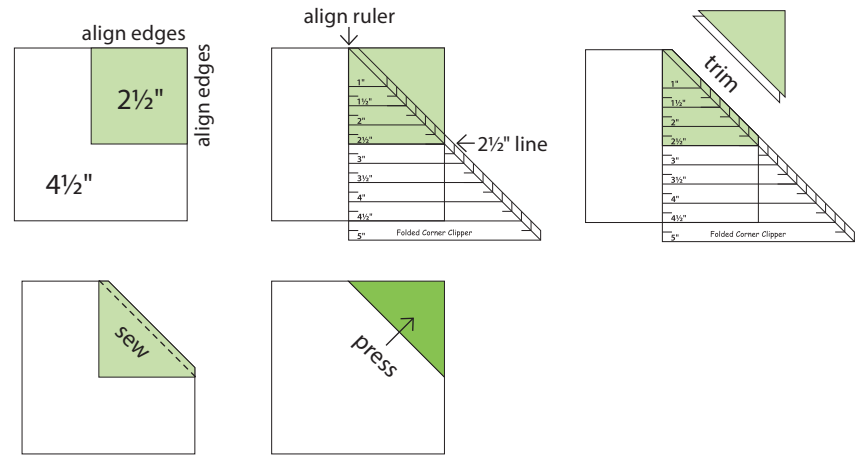

(B) Repeat, aligning a 2½" Green square on the opposite corner of the same Background square as shown. Make a total of 160 units.

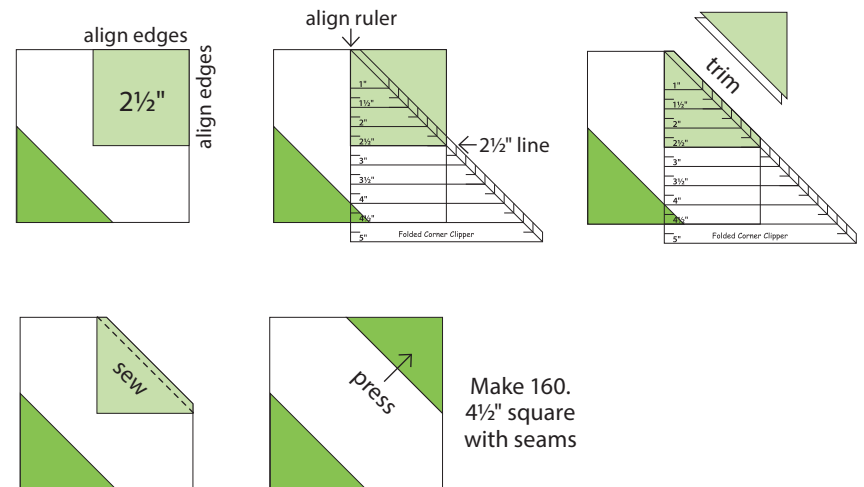

"X" Blocks continued.

(C) Join 4 units to make one "X" Block. Make a total of 40 "X" Blocks.

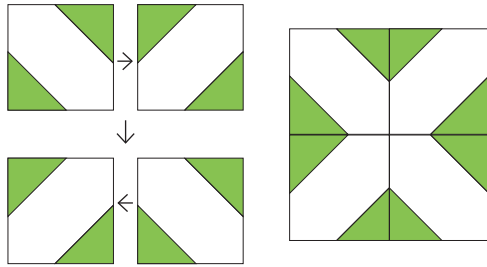

"X" Block
Make 40.
8½" square
with seams

moda

2 16 Patches: From each of 2 different prints select 2-2½" x 10" strips. Sew the strips together as shown. Cut 4-2½" x 8" segments from the strip set. Join the units, rotate every other unit as shown, to make one 16 Patch Block. Repeat to make 40-16 Patch Blocks.

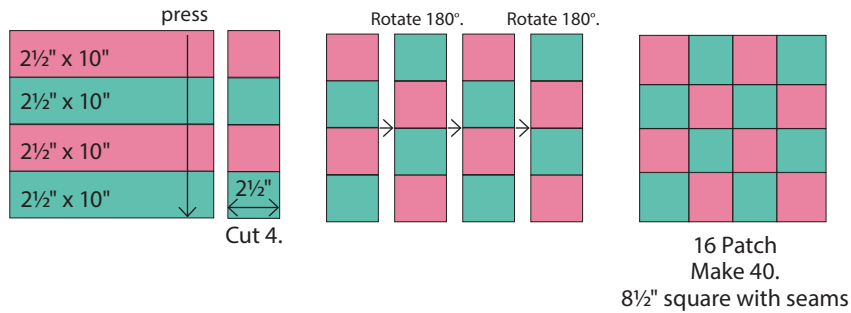

16 Patch
Make 40.
8½" square with seams

3 Decide on the placement of the 16 Patches before assembling the rows. Join 4-"X" Blocks and 4-16 Patches, alternating the blocks, to make one row. Make 10 rows.

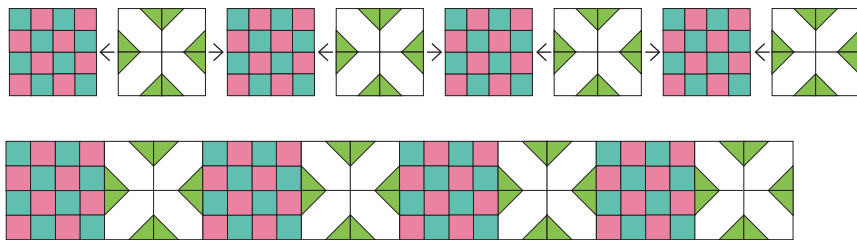

Make 10 rows.
8½" x 64½" with seams

4 Assembly: Combine the rows. Rotate every other row 180°.

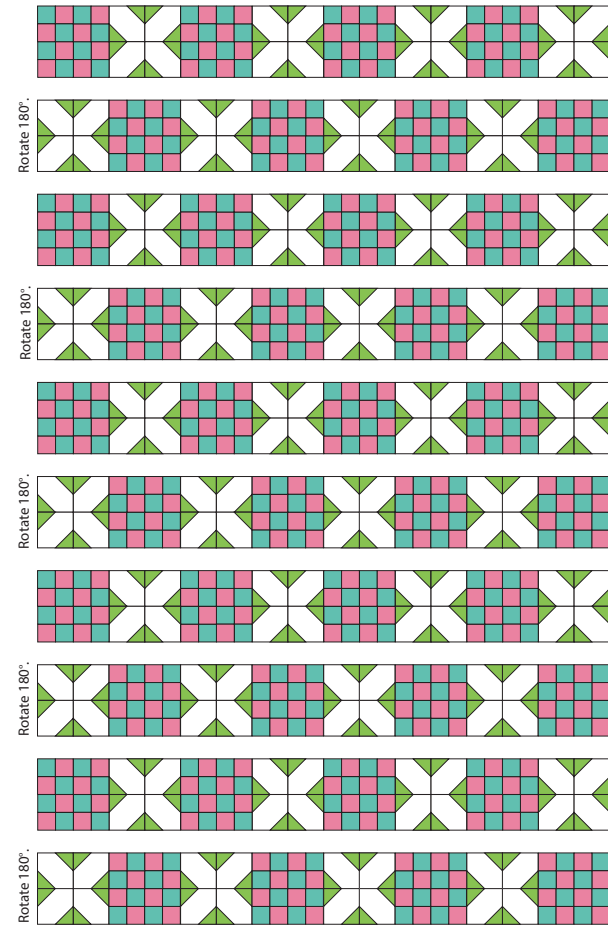

5 Rick Rack: Use a straight stitch and matching thread to add the rick rack to the quilt top as shown. (You can add the rick rack after the top is quilted if you prefer.)

Layer, quilt and bind. ENJOY!

