

Block 13

Supplies & Cutting

Dark: (9" x 11")

cut carefully, you will be using 8" of the 9" wide strip
4-2" x 11" strips

cut the 4 strips into 4-2" x 3 1/2" rectangles
8-2" x 2" squares

Medium: (9" x 11")

cut carefully, you will be using 8" of the 9" wide strip
4-2" x 11" strips

cut the 4 strips into 4-2" x 3 1/2" rectangles
8-2" x 2" squares

Light: (9" x 22")

1-3 1/2" x 22" strip

cut the 1 strip into 5-3 1/2" x 3 1/2" squares

2-2" x 22" strips

cut the 2 strips into 16-2" x 2" squares

Use a 1/4" seam allowance.

Press in the direction of the arrows.

Quilt Construction

Draw a diagonal line on the wrong side of 8-2" x 2" Dark, 8-2" x 2" Medium, and 16-2" x 2" Light squares.

- 1** (A) Layer, right sides together, 1-2" x 2" Medium square on 1-3 1/2" x 3 1/2" Light square as shown. Sew on the diagonal line. Trim 1/4" from the diagonal line. Press to the corner to form the triangle. Repeat on the opposite corner of the square. Make 4.

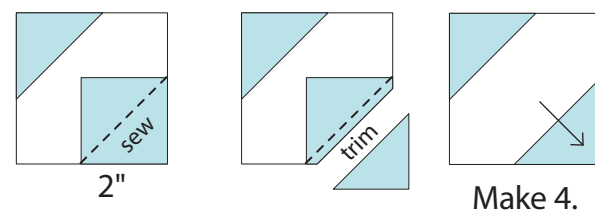
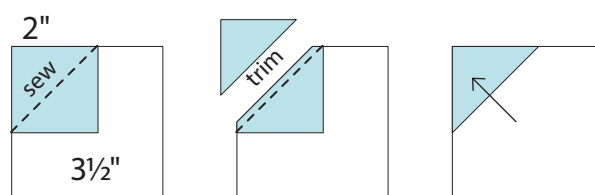

- (B) Layer, right sides together, 1-2" x 2" Dark square on the previous unit as shown. Sew on the diagonal line. Trim 1/4" from the diagonal line. Press to the corner to form the triangle. Repeat on the opposite corner of the square. Make 4.

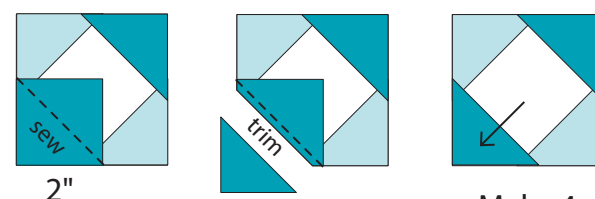
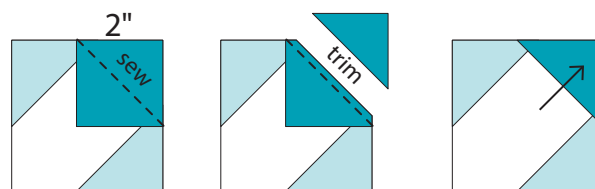

Make 4.
3 1/2" x 3 1/2"
with seams

2 (A) Layer, right sides together, 1-2" x 2" Light square on 1-2" x 3½" Medium rectangle as shown. Sew on the diagonal line. Trim ¼" from the diagonal line. Press to the corner to form the triangle. Repeat on the opposite corner of the rectangle. Make 4.

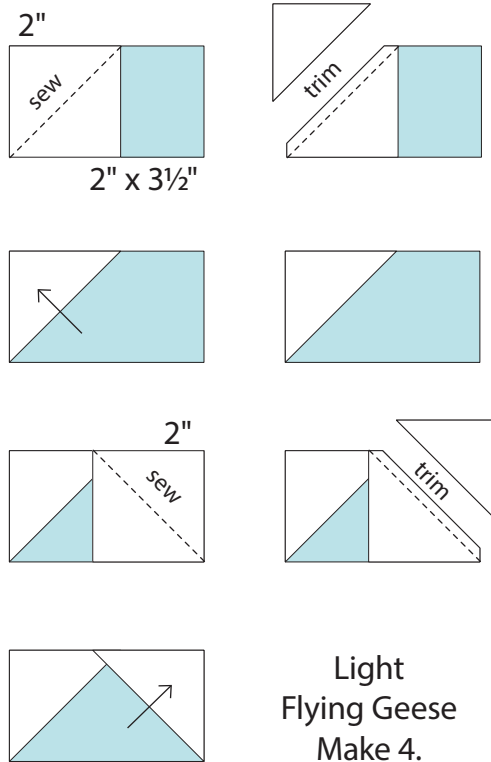

(B) Repeat using 1-2" x 3½" Dark rectangle. Make 4.

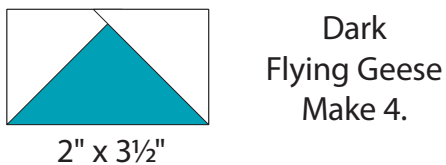

3 Join 1 Light and 1 Dark Flying Geese block as shown. Make 4.

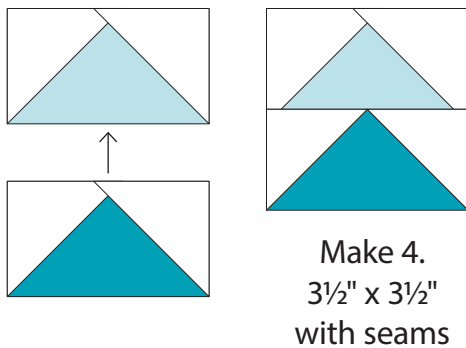

4 Assembly: Sew the block parts into rows as shown. Press in the direction of the arrows. Combine the rows.

